



Undergraduate Open Day Guide

Saturday 7 October 2023

**DON'T
JUST
STUDY
HERE**

BELONG

Welcome to Glasgow Caledonian University

We hope you find today useful in guiding you through the next exciting step - choosing a degree. Our Open Day will allow you to explore our modern and vibrant city centre campus and give you the opportunity to find out more about the extensive range of courses the University has to offer.

Academic representatives from the University's academic schools and representatives from various support departments will be on hand to answer any questions you may have. There is also a comprehensive programme of talks on specific subjects throughout the day, as well as tours of key facilities. Details are available in this guide.

Why not familiarise yourself with the campus and our accommodation facilities by taking part in our scheduled tours? Our three academic schools will also be providing tours of their specialised labs and facilities. For further information on what you can expect from the tours, staff and student helpers will be on hand to provide advice and guidance at our information stands situated across the campus.

We hope you enjoy your day at Glasgow Caledonian University, and remember to ask our student helpers wearing purple hoodies / T-shirts for directions or information.

Plan your day

- **Opening times:** The University will be open to visitors from 10am-2pm on Saturday 7 October, 2023.
- **Check in:** Make sure you register when you arrive and receive your Open Day Information Pack. This will help plan your day around visiting the information stands, talks and tours.
- **Campus tours:** A great way to see the campus without getting lost is going on one of our guided campus tours. You can also use the campus map on pages nine and ten.
- **Catering:** Our campus caterers, Baxter Storey will have outlets open during the day in the Sir Alex Ferguson Library and the George Moore building.
- **Post a photo to win a prize:** Take a snap on your own or with friends at our Open Day. There are various photo locations on campus, look out for these areas, including our large deckchair. Follow us on Instagram, @glasgow_caledonian_university and share on social media using the hashtag #gcuopenday to win Amazon vouchers that we will be giving away on the day.



Support services information stands, talks and tours

Talks for the academic school courses are listed on pages 5-7 of this programme. If you are unable to attend one of the scheduled talks then you can visit the relevant information stand for that course where you can speak to someone.

General Information Talks

Welcome talk

Welcome and find out more about GCU from the university
10.10-10.50am: Room W011, Annie Lennox building

Applying to university

UCAS process and personal statement
11-11.30am: Room W110, 1st Floor Annie Lennox building
1.15-1.45pm: Room W110, 1st Floor Annie Lennox building

Languages

Find out about adding a language to your degree
11.45-12.15pm: Room W110, 1st Floor Annie Lennox building

Exchange and study abroad

Find out about studying abroad as part of your degree
12.30-1pm: Room W110, 1st Floor Annie Lennox building

Supporting you at university

Find out about the support we offer from Counselling, Mental Health and Disability Advice.
11.45-12.15: Room W118, 1st Floor Annie Lennox building

Graduate Apprenticeships

Find out about the range of Graduate Apprenticeships we offer and our links with industry.
11-11.30am: Room W118, 1st Floor Annie Lennox building

Information stands

The University is committed to providing excellent facilities and resources to support students' learning. This includes looking after all aspects relating to the health and welfare of our students while they are studying with us. To find out more about the support available to students studying at the University, visit the Support Services situated in the Annie Lennox building.

- **Accommodation Office:** Room W007, Get advice on GCU accommodation options.
- **Admissions Office:** Visit our Admissions Office staff to receive advice on application and entry requirements, Admissions are located on the first floor of the Annie Lennox building.
- **Careers and Employability Service:** Find out how our careers service can support you in managing your own career development and employability.
- **College Connect Team:** Chat to our team about the transition and support for students applying from college.
- **Student Wellbeing Team:** Speak to our team to find out more about our approach to supporting students through mental health, wellbeing, counselling and disability advice.
- **Exchange and study abroad:** Find out about studying abroad as part of your degree.
- **Funding, Bursaries and Scholarships Team:** Find out about tuition fees and what further scholarships and bursaries may be available to help with your studies.
- **Graduate Apprenticeships:** Find out about our links with industry and range of courses available to study on a blended learning approach.
- **Languages:** Information on adding a language to your degree.
- **Learning Development Centre:** Find out about the additional support we have for students during their academic studies at GCU.
- **Students' Association:** (Main concourse outside and Student Association building) Information on clubs, societies and support available.
- **VISA:** Find out about support across various key areas including Student visa applications, visa conditions, post-study work options, and more.

Tours

- **Campus tours (approx. 30 mins):** With our tour guides, take a general tour of the campus visiting the Sir Alex Ferguson Library, sports facilities, Students' Association, places to eat and other main areas. (Accommodation not included on this tour). Please meet outside the George Moore building. Campus tours will depart throughout the day from 10.15am.
- **Accommodation (Caledonian Court):** Please note due to full occupancy and building works we may be unable to let you view inside the accommodation rooms. If you wish to view where the accommodation is and see the grounds then join a tour leaving from outside the George Moore building. Our accommodation staff are available in room W007 to show you a video and chat about our accommodation.
- **Academic facility tours:** Our academic schools will also be conducting tours of specialised facilities, such as our fashion factory, clinical simulation labs, and computer and engineering labs. Please see the times detailed in this guide or visit the relevant stands for further information.



Glasgow School for Business and Society



Course stands

Location: Annie Lennox building

Representatives will be available from this school to answer questions on the following courses:

Degrees in Accountancy, Finance and Risk

- Accountancy
- Finance, Investment and Risk
- Risk Management

Degrees in Business and Management

- Business Management
- International Business
- International Business with Languages
- International Business and Human Resource Management
- International Supply Chain Management

Degrees in Fashion, Marketing, Tourism and Events

- Fashion Design with Business
- International Fashion Branding
- International Marketing
- International Tourism and Events Management

Degrees in Journalism and Media Studies

- Media and Communication
- Multimedia Journalism

Degrees in Economics and Law

- LLB Law (Bachelor of Laws)
- Economic Policy

Degree in Social Sciences

- Social Sciences

Talks

11-11.30am

- **Accountancy:** Room W622, Annie Lennox building
- **Media and Communications:** Room M323, George Moore building
- **LLB Law:** Room W011, Annie Lennox building

11.45-12.15pm

- **International Business, Business Management and International Supply Chain Management:** Room W011, Annie Lennox building
- **Multimedia Journalism:** Room M323, George Moore building
- **Risk Management:** Room W119, Annie Lennox building
- **Languages:** Room W110, Annie Lennox building

12.30-1pm

- **Fashion, Marketing, Tourism and Events:** Room C001, Charles Oakley building
- **Finance, Investment and Risk:** Room W118, Annie Lennox building

1.15-1.45pm

- **Social Sciences:** Room W011, Annie Lennox building

Tours

Please meet at the locations noted, or speak with staff on the course information stands in the Annie Lennox building.

- **Fashion Factory**
10.30am, 11.15am and 12pm: meet at course information stand in Annie Lennox building
1pm: after talk from room C001
- **Media and Journalism facilities**
11.30am: after talk from room M323
12.15pm: after talk from room M323
- **Law facilities**
11.30am: after talk from room W011 or meet Floor 3, Annie Lennox building
- **Bloomberg Finance Suite**
1pm: after talk from room W118, Annie Lennox building



School of Computing, Engineering and Built Environment

Course stands

Location: Annie Lennox building

Representatives will be available from this school to answer questions on the following courses:

Degrees in Applied Computer Games

- 3D Animation and Visualisation
- Digital Design
- Games Development

Degrees in Computing

- AI and Data Science
- Computing
- Software Development

Degrees in Cyber Security and Networking

- Cyber Security and Networks
- Digital Security and Forensics

Degrees in Engineering

- Audio Technology
- Electrical and Electronic Engineering
- Electrical Power Engineering
- Environmental Civil Engineering
- Mechanical Engineering

Degrees in Applied Science

- Forensic Investigation

Degrees in Construction and Built Environment

- Building Services Engineering
- Building Surveying
- Construction Management
- Environmental Management
- Quantity Surveying

Talks

11-11.30am

- **Building Services Engineering:** Room M408, George Moore building
- **Degrees in Computing:** Room M137, George Moore building
- **Digital Design:** Room C119, Charles Oakley building
- **Mechanical Engineering:** Room M404, George Moore building

11.45-12.15pm

- **Audio Technology:** Room M319, George Moore building
- **Building Surveying:** Room M408, George Moore building
- **Computer Games Development:** Room M714, George Moore building
- **Environmental Civil Engineering:** Room M404, George Moore building
- **Forensic Investigation:** Room M705, George Moore building

12.30-1pm

- **Cyber Security and Networking courses:** Room M323, George Moore building
- **Quantity Surveying and Construction Management:** Room M408, George Moore building
- **Electrical and Electronic Engineering and Electrical Power Engineering:** Room M404, George Moore building
- **Environmental Management:** Room M319, George Moore building
- **3D Animation and Visualisation:** Room C117, Charles Oakley building

Tours

Please meet at the locations noted, or speak with staff on the course information stands in the Annie Lennox building.

- **3D Animation and Visualisation:** 1pm after talk from room C117
- **Audio Technology:** 11.30am meet at the course stand 12:15pm after talk from room M319
- **Computer Games labs:** 11am meet at the course stand 12:15pm leaving after talk from room M714 1:30pm, meet at the course stand
- **Digital Design:** 11.30am leaving after talk from room C119
- **Forensics labs:** 12.15pm leaving after talk from room M705
- **Electrical and Electronic Engineering/Electrical Power Engineering:** 11am meet at the course information stand 1pm leaving after talk from Room M404
- **Environmental Civil Engineering:** 12.15pm leaving after talk from Room M404
- **Mechanical Engineering:** 11.30am leaving after talk from room M404
- **Networking and Security labs:** 1pm leaving after talk from room M323 or visit the course information stand for further tours.

School of Health and Life Sciences



Course stands

Representatives will be available from this school to answer questions on the following courses:

Location: Annie Lennox building

Degrees in Health and Social Care

- Diagnostic Imaging
- Occupational Therapy
- Oral Health Science
- Human Nutrition and Dietetics
- Physiotherapy
- Podiatry
- Radiotherapy and Oncology
- Social Work

Degrees in Psychology

- Applied Psychology

Degrees in Biological and Biomedical Sciences

- Applied Biomedical Science / Biomedical Science
- Biological Sciences
- Food Science
- Pharmacology

Degrees in Vision Sciences

- Optometry
- Orthoptics
- Ophthalmic Dispensing Management

Location: Govan Mbeki building

Degrees in Nursing

- Adult
- Child
- Learning Disability
- Mental Health

Degrees in Paramedic Science

- Paramedic Science

Talks

11-11.30am

- **Optometry, Orthoptics and Ophthalmic Dispensing:** Room W115, Annie Lennox Building
- **Oral Health Science:** Room: W301, Annie Lennox Building
- **Psychology:** Room C001, Charles Oakley building

- **Nursing: Nursing Studies (Adult, Child, Mental Health and Learning Disability):** Room A005, Govan Mbeki building

11.45-12.15pm

- **Biological and Biomedical Sciences:** Room C001, Charles Oakley building
- **Diagnostic Imaging / Radiotherapy and Oncology:** Room W301, Annie Lennox Building
- **Paramedic Science:** Room A005, Govan Mbeki building
- **Podiatry:** Room: W115, Annie Lennox building

12.30-1pm

- **Human Nutrition and Dietetics:** Room M137, Geroge Moore building
- **Nursing: Nursing Studies (Adult, Child, Mental Health and Learning Disability):** Room A005, Govan Mbeki building
- **Occupational Therapy:** Room W115, Annie Lennox building
- **Physiotherapy:** Room W011, Annie Lennox building
- **Social Work:** Room W301, Annie Lennox building

1.15-1.45pm

- **Nursing: Nursing Studies (Adult, Child, Mental Health and Learning Disability):** Room A005, Govan Mbeki building

Tours

Please meet at the locations noted, or speak with staff on the course information stands in the Annie Lennox building.

- **Inter-Professional Simulation Centre Patient Journey**
Visit the facilities our students use when studying our Nursing, Diagnostic Imaging, Radiotherapy and Oncology, Occupational Therapy, Physiotherapy, Podiatry and Paramedic Science courses. Stop by at any time during our Open Day to see how these courses work together and to speak with students about their experiences. Please make your way to the 3rd floor of the Govan Mbeki building.
- **Vision Centre tours**
10.30am: leaving from course information stand in Annie Lennox building.
11.30am: leaving after talk from room W115.
- **Bioscience labs**
12:15pm: Leaving after talk from room C001.

Safety on campus

It is important that you are aware of the safety requirements while on the campus.

If the fire alarm sounds please vacate the building by the nearest signposted exit. Do not use any of the lifts and wait outside until told by a member of University staff that the building is safe to re-enter.

Please comply with the 'No Entry' and 'No Open Day Access' signs around the campus.

Please do not touch any specialised equipment while on tours of facilities unless asked to do so by a member of staff.

If you require any medical attention please contact one of our Open Day Student Helpers or visit any of the University reception areas.

Please use hand sanitiser stations located throughout the campus.

Please note: Filming and photography by GCU staff will be taking place at our Open Day. Please speak with the photographers if you want to withdraw consent.



Explore the University

Situated in the heart of Glasgow city, Glasgow Caledonian University is your new home from home.

- 01 Annie Lennox building**
This is where the main information stands for our Open Day will be (Rooms W)
- 02 Sir Alex Ferguson Library**
Home to the University library, with PC access, study spaces and cafe facilities
- 03 George Moore building**
George Moore building contains the refectory and grab and go cafe (Rooms M)
- 04 Govan Mbeki building**
Course Information stands for Nursing and Paramedic Science courses and tours for our health and the vision sciences courses (Rooms A)
- 05 Students' Association**
The Student Association is home to our SA officers as well as social spaces and our student bistro
- 06 Arc Health and Wellbeing**
The Arc Health and Wellbeing hosts our on-site gym alongside beauty and hairdressing facilities
- 07 Centre for Executive Education**
- 08 William Harley building**
- 09 Britannia building**
- 10 Charles Oakley Laboratories**
Charles Oakley laboratories, home to many of our Engineering and Built Environment facilities (Rooms C)
- 11 Teaching block**
- 12 Milton Street building**
Milton Street building is home to the Fashion Factory as well as the Graduate School (Rooms MS)
- 13 Nursery**
- 14 Caledonian Court**
Caledonian Court is our on-site student accommodation
- 15 Campus and accommodation tour meeting point**
- 16 Open Day registration desk**

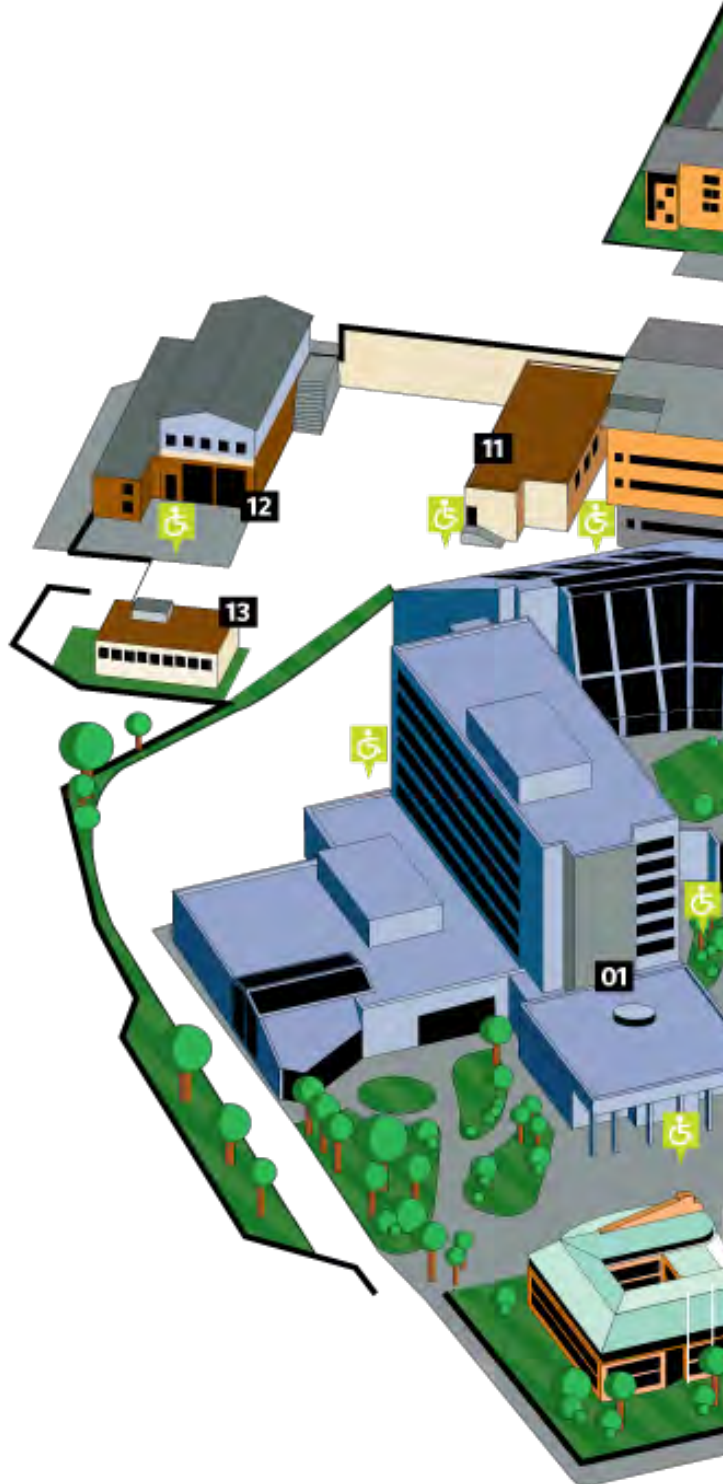

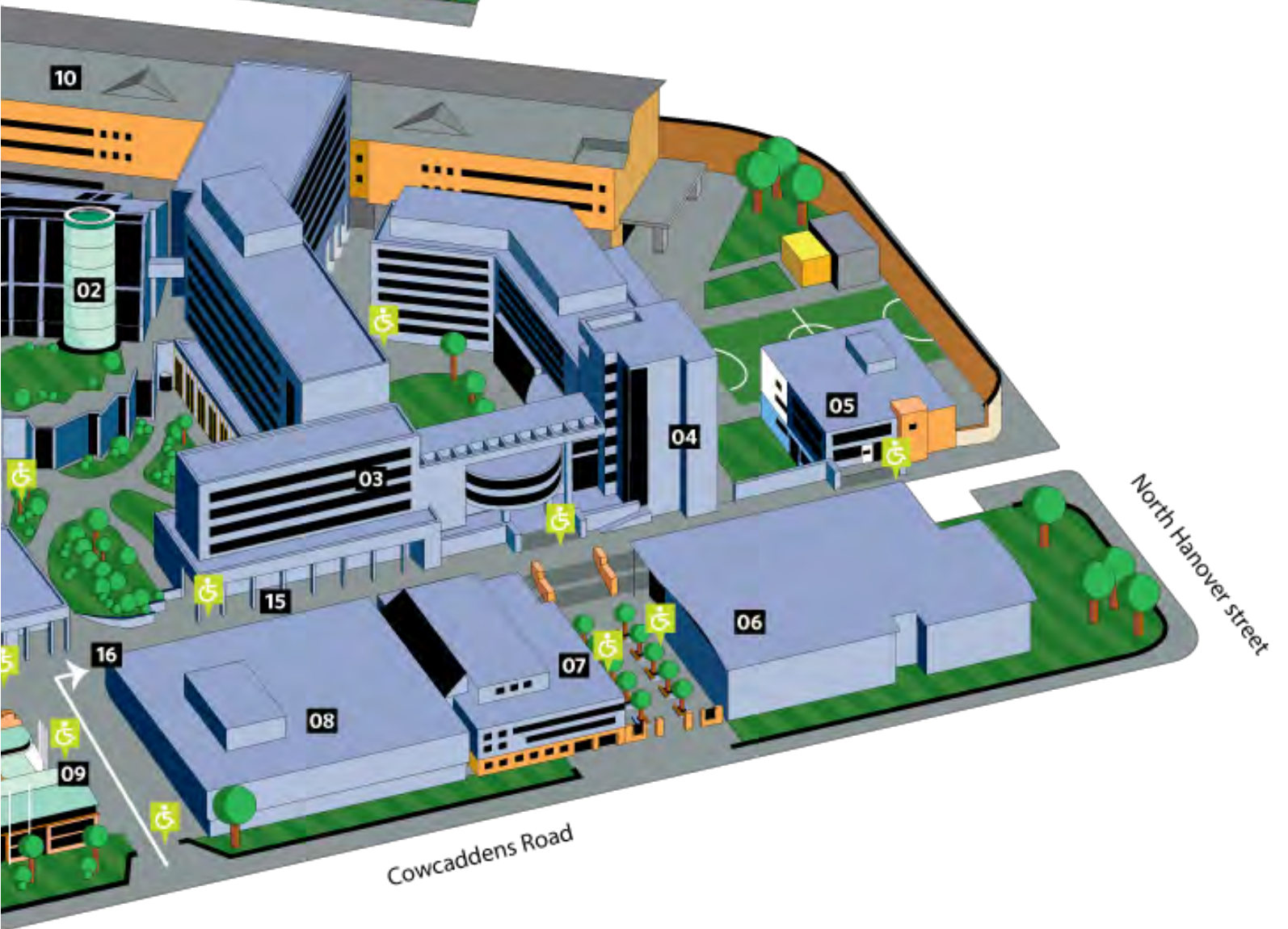
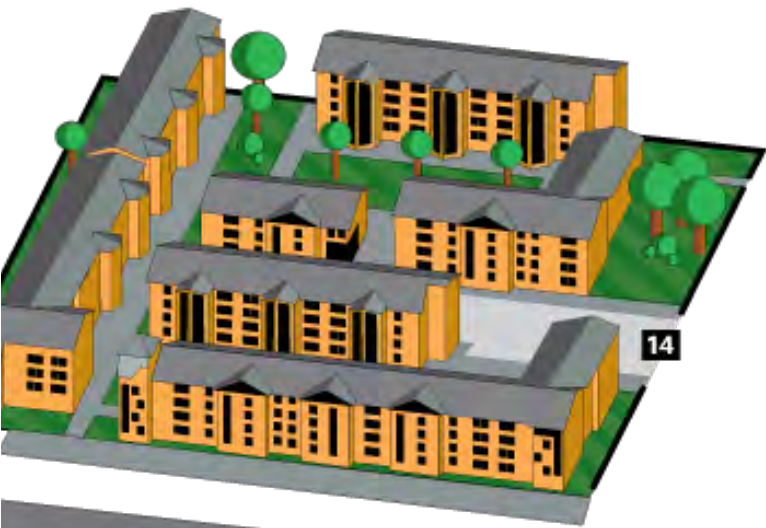



Glasgow Caledonian University
Cowcaddens Road, Glasgow, G4 0BA
+44 (0)141 331 3000
gcu.ac.uk

Connect with us on social

[instagram.com/glasgow_caledonian_university](https://www.instagram.com/glasgow_caledonian_university)
[facebook.com/GlasgowCaledonianUniversity](https://www.facebook.com/GlasgowCaledonianUniversity)
[youtube.com/watchgcu](https://www.youtube.com/watchgcu)
twitter.com/caledoniannews
[linkedin.com/school/glasgow-caledonian-university](https://www.linkedin.com/school/glasgow-caledonian-university)
[tiktok.com/@glasgowcaluni](https://www.tiktok.com/@glasgowcaluni)